

NORTHALL VILLAGE TRUST

Registered Charity No. 1117673



AGM

Friday 29th June 2018

AGM June 2018

NORTHALL VILLAGE TRUST – AGM 2018

Agenda

- 1. Welcome** Alan Tipper
- 2. Apologies** Alan Tipper
- 3. Minutes of the AGM held on 30.06.2017** Alan Tipper
- 4. Trustees Annual Report for 2017** Alan Tipper
- 5. Accounts for the year ended 31.12.17** Kevin Cabbage
- 6. Election of Management Committee** Alan Tipper
- 7. Any Other Business** Alan Tipper

4. Trustees Annual Report for 2017

NORTHALL VILLAGE HALL MANAGEMENT COMMITTEE

Our Mission

To provide Northall (and local area) residents with a village hall that is suitable for community groups and family parties for up to 60 people and which is amongst the best for cleanliness, décor, equipment, facilities, safety - and value for money

4. Trustees Annual Report for 2017

Hiring Fees

- Fees were maintained at **£5.50** per hour for regular users and **£7.00** per hour for Ad Hoc users
- Fees were also maintained at **£12** per hour for people living outside the four villages of Edlesborough, Eaton Bray, Dagnall and Northall
- **Lowest village hall hiring fees in area**

4. Trustees Annual Report for 2017

<u>Hall Usage & Hiring Income</u>	2016	2017	% Change over 2016
Hall Usage (Hrs) (Regular)	930	1084	+16.5%
Hall Usage (Hrs) (Ad Hoc)	543	422	-22.3%
Hiring Income (£) (Regular)	5,223	5,865	+12.3%
Hiring Income (£) (Ad Hoc)	4,359	4,400	+1.8%

4. Trustees Annual Report for 2017

Book Library/ Swap



£16.07 raised towards the cost of bedding plants/Spring bulbs for Village Hall grounds. Funds available for plants currently stands at £8.20

4. Trustees Annual Report for 2017

PV Solar Panels



During 2017 £1,103 was earned by the solar panel installation. This is a decrease on 2016 but the income for 2016 also included income for the last quarter of 2015.

4. Trustees Annual Report for 2017

Village Hall Grounds

The grounds are regularly maintained by the employment of a professional contractor, one volunteer gardener and the Village Hall Committee



4. Trustees Annual Report for 2017 Kitchen Extension/Renovation

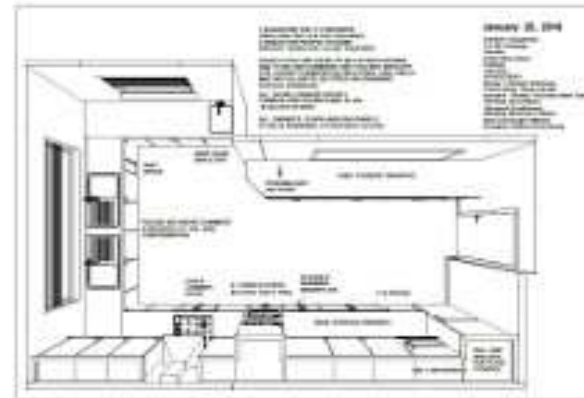

Grant application to AVDC Community Chest for £17,192 was approved in September 2016.

Grant re-application to WREN for £35,816 was approved in December 2017

The foundations, outside shell and roof of the kitchen extension were completed in March 2018

The builders will return on the 25th July to complete the project with completion expected by early September.

4. Trustees Annual Report for 2017 AGM 2017

The AGM was held on Friday the 30th June and was attended by the local residents of Northall. As there was a possibility that building work would be in progress on the extension and renovation of the Village Hall kitchen it was decided not to combine the event with a BBQ picnic fun day.

4. Trustees Annual Report 2017

Soft Play Equipment

The Soft Play Equipment which was purchased in 2014 has continued to be popular and contributed the sum of £390 in respect of hiring fees towards the Hall's income, a decrease of 5% on 2016



Key Issues & Future Plans

- **Continue driving Vision of making NVH one of “*...the best for cleanliness, décor, equipment, facilities, safety - and value for money*”**
- **Extension, refurbishment and modernisation of the kitchen to include new sink, cooker and fridge. Work started in February and is due for completion in early September 2018.**
- **Sensory garden in area on the south side of the hall.**
- **Consider extending Car Park & re-lining**

NORTHALL VILLAGE TRUST – AGM 2018

Agenda

- 1. Welcome** Alan Tipper
- 2. Apologies** Alan Tipper
- 3. Minutes of the AGM held on 30.06.17** Alan Tipper
- 4. Trustees Annual Report for 2017** Alan Tipper
- 5. Accounts for the year ended 31.12.2017** Kevin Cabbage
- 6. Election of Management Committee** Alan Tipper
- 7. Any Other Business** Alan Tipper

5. Accounts for the year ended 31st December 2017

Income

2016		2017
9,582	Hall Lettings	11,882
	- AVDC/VAHT Community Chest Grant	13,343
4	Interest on Reserve A/C	3
1,235	PV Project-FIT Payments received	1,103
<u>1,263</u>	Donations - Cash received by NVHMC	<u>16</u>
12,084		26,347

Expenditure

2016

2017

1,356	Fixtures, Fittings, Equipment & Furniture	439
251	Repairs & Maintenance	990
1,597	Cleaning & Materials	1,629
1,346	Electricity (Light & Heat) + Water	823
738	AGM/Barbecue	25
549	Printing, Postage, Stationery, Tel; PRS; Sundries	502
671	Insurance	693
-	Kitchen Extension	120
300	Solar Panels	-
<hr/>		<hr/>
6,808		5,221

2016		2017
12,084	Income	26,347
6,808	Expenditure	5,221
<hr/>		<hr/>
5,276	Surplus/Deficit Income over Expenditure	21,126
11,193	Surplus B/F from previous year	16,469
<hr/>		<hr/>
16,469	Surplus C/F	37,595
<hr/>		<hr/>

Represented by:

2016		2017
	- CAF-Current A/C	3,590
	- CAF –Gold A/C	32,312
34	Petty Cash	2
8,468	NatWest - Current A/C	1,691
7,967	- Reserve A/C	-
<hr/>		<hr/>
16,469		37,595
<hr/> <hr/>		<hr/> <hr/>

Reserves Policy

- **Operating Reserves**, equivalent to 12 months minimum expenditure (currently £5,000), as a contingency against losing Regular Users, economic recession, fall in hiring income etc.
- **Building Reserves** of £4,000 to carry out emergency repairs, emergency replacement of essential equipment etc.
- **Sinking Fund** for the on-going improvement of the fabric, décor and facilities of the Hall (£3,000).
- **Possible Hall improvement projects** planned over the next few years (£7,000).

BALANCE SHEET FOR THE YEAR ENDED 31ST DECEMBER 2017

£

Fixed Assets:

Land (Price paid when purchased in 1981) **2,000**

Hall, Storage Building & Car park
(Current insured value) **285,458**

Hall Equipment & Furniture
(Current insured value) **15,344**

PV Solar Panels **9,000**

Play Area Equipment & Seats (current insured
value) **68,760**

Total Fixed Assets **380,562**

BALANCE SHEET FOR THE YEAR ENDED 31ST DECEMBER 2017

Total Fixed Assets **380,562**

Current Assets

Stocks - no stocks are held -

Debtors - as these Accounts have been prepared on a
'Receipts & Payments' basis, there are no Debtors -

Bank & Cash - as per 'Receipts & Payments' **37,595**

37,595

Current Liabilities

Creditors - as these Accounts have been prepared on a
'Receipts & Payments' basis, there are no Creditors -

Net Current Assets **37,595**

TOTAL ASSETS **418,157**

**NOTES TO THE ACCOUNTS FOR THE YEAR ENDED 31ST
DECEMBER 2017**

**Donations from Edlesborough Parish Council
towards the cost of running NVH & Play Area**

2016

(Nett of VAT)

321.43 Play Equipment Insurance

108.33 RoSPA Annual Safety Inspection and Report

- Repairs to G Force Roundabout

1,373.00 Grass and Hedge Cutting of Hall Grounds & Play Area

**1,802.76 Total Donations where Edlesborough Parish Council
paid the Suppliers direct and recovered the VAT**

2017

(Nett of VAT)

333.81

65.00

525.00

1,265

2,188.81

NORTHALL VILLAGE TRUST-AGM 2018

Agenda

- 1. Welcome** Alan Tipper
- 2. Apologies** Alan Tipper
- 3. Minutes of the AGM held on 30.06.17** Alan Tipper
- 4. Trustees Annual Report for 2017** Alan Tipper
- 5. Accounts for the year ended 31.12.2017** Kevin Cabbage
- 6. Election of Management Committee** Alan Tipper
- 7. Any Other Business** Alan Tipper

6. Election of Management Committee

Committee Member	Since	Representing	Current Office	Willing to continue
Alan Tipper	2005		Chairman	
Kevin Cubbage	1989	Edlesborough Parish Council	Treasurer	
Lorna Cubbage	1982	Parochial Church Council	Joint Bookings' Secretary	
Richard Dorrance	2006		Secretary	
Jackie Matthew	Jan 2017		Joint Bookings' Secretary	
Meuryn Thomas	2014	Age Concern		
Anthony Cox	Jul 2014	Northall Baptist Chapel		
Sarah Pratt	June 2016			
Richard Harpley	May 2017			

NORTHALL VILLAGE TRUST – AGM 2018

Agenda

- 1. Welcome** *Alan Tipper*
- 2. Apologies** *Alan Tipper*
- 3. Minutes of the AGM held on 30.06.17** *Alan Tipper*
- 4. Trustees Annual Report for 2017** *Alan Tipper*
- 5. Accounts for the year ended 31.12.17** *Kevin Cabbage*
- 6. Election of Management Committee** *Alan Tipper*
- 7. Any Other Business** *Alan Tipper*

NORTHALL VILLAGE TRUST

Registered Charity No. 1117673

